

MFJ (JIS Flange Type Formed Bellows)



Pressure condition: Inside: Vacuum, Outside: Atmospheric pressure

Temperature: < 250° C

Helium leak rate: < 1×10^{-9} Pa·m³/sec

Material: Bellows: SUS316L, Flange: SUS304

Guaranteed life cycle: 10,000 cycles

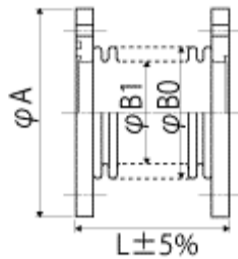

Figure: Flange both sides fixed

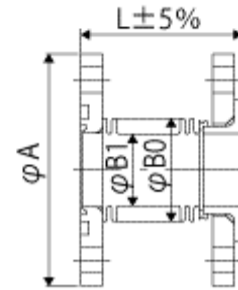

Figure: Flange one side fixed, the other side rotating

List of JIS Flange Type Formed Bellows (with Flange fixed on both sides)

Code	Flange	φ A	B1	B0	t	L1	L2	K	Ae
MFJ-020	JIS 20A	80	22.5	33	0.15	60	54-64	14.7	6.2
MFJ-025	JIS 25A	90	28.0	40	0.15	65	57-70	10.8	9.2
MFJ-040	JIS 40A	105	42.7	58	0.15	90	74-100	5.9	20.1
MFJ-050	JIS 50A	120	49.5	65	0.15	105	85-118	5.9	26.1
MFJ-065	JIS 65A	145	61.0	80	0.15	110	83-128	4.9	39.5
MFJ-080	JIS 80A	160	77.0	95	0.15	110	89-124	6.9	58.5
MFJ-100	JIS 100A	185	105.5	125	0.15	110	88-124	8.8	105.2
MFJ-125	JIS 125A	210	134.0	153	0.15	100	82-112	10.8	162.4
MFJ-150	JIS 150A	235	156.5	176	0.15	100	82-112	14.7	217.9
MFJ-200	JIS 200A	300	204.0	240	0.3	125	145-105	14.7	387.1
MFJ-250	JIS 250A	350	254.0	290	0.3	125	140-102	21.9	581.1

List of JIS Flange Type Formed Bellows (with Flange fixed on one side)

Code	Flange	φ A	B1	B0	t	L1	L2	K	Ae
MFJ-020-R	JIS 20A	80	22.5	33	0.15	60	64-56	9.2	6.1
MFJ-025-R	JIS 25A	90	28.0	40	0.15	65	70-59	6.9	9.1
MFJ-040-R	JIS 40A	105	42.7	58	0.15	90	100-78	4.0	19.9
MFJ-050-R	JIS 50A	120	49.5	65	0.15	105	118-91	3.8	25.7
MFJ-065-R	JIS 65A	145	61.0	80	0.15	110	128-92	2.4	39.0
MFJ-080-R	JIS 80A	160	77.0	95	0.15	110	124-96	5.2	58.1
MFJ-100-R	JIS 100A	185	105.5	125	0.15	110	124-95	6.0	104.3
MFJ-125-R	JIS 125A	210	134.0	153	0.15	100	112-88	9.8	161.7
MFJ-150-R	JIS 150A	235	156.5	176	0.15	100	111-89	11.9	217.1

L1: Standard manufacturing length, L2: Operating range, K(N/mm): Spring constant, Ae(cm²): Effective area

※Please contact us for the information on length other than the standard length.



MIRAPRO

1100 Anadaira Sutama-cho Hokuto Yamanashi, Japan

Sales Department FAX 0551-42-5556 e-mail mpccom@mirapro.co.jp

MFK (KF Flange Type Formed Bellows)



Pressure condition: Inside: Vacuum, Outside: Atmospheric pressure
 Temperature: < 250° C
 Helium leak rate: < 1×10^{-9} Pa·m³/sec
 Material: Bellows: SUS316L, Flange: SUS316
 Guaranteed cycle time: 10,000 cycles

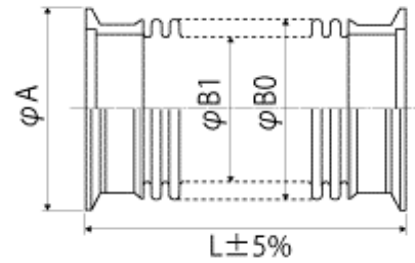

List of KF Flange Type Formed Bellows

Code	Size	ϕA	B1	B0	t	L1	L2	K	Ae
MFK-010	KF 10	30	22.5	33.0	0.2	105	96-111	9.8	6.2
MFK-016	KF 16	30	22.5	33.0	0.2	105	96-111	9.8	6.2
MFK-025	KF 25	40	22.5	33.0	0.2	105	96-111	9.8	6.2
MFK-040	KF 40	55	42.7	58.0	0.2	115	100-130	5.9	20.1
MFK-050	KF 50	75	49.5	65.0	0.2	125	110-140	5.9	26.0
MFK-063	KF 63	87	61.0	80.0	0.2	130	110-140	5.9	39.5
MFK-080	KF 80	114	89.7	109.0	0.2	150	130-170	5.9	77.8
MFK-100	KF 100	134	105.5	125.0	0.2	150	130-170	7.8	105.2

L1: Standard manufacturing length, L2: Operating range, K(N/mm): Spring constant, Ae(cm²): Effective area
 ※Please contact us for the information on length other than the standard length.



MIRAPRO

1100 Anadaira Sutama-cho Hokuto Yamanashi, Japan
 Sales Department FAX 0551-42-5556 e-mail mpccom@mirapro.co.jp

MFC (CF Flange Type Formed Bellows)



Pressure condition: Inside: Vacuum, Outside: Atmospheric pressure

Temperature: < 250° C

Helium leak rate: < 1 × 10⁻⁹ Pa•m³/sec

Material: Bellows: SUS316L, Flange: SUS316

Guaranteed cycle time: 10,000 cycles

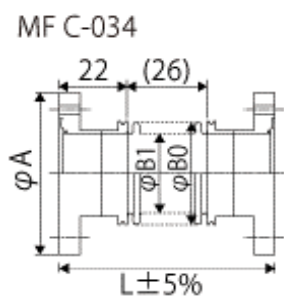

Figure: Flange both sides fixed

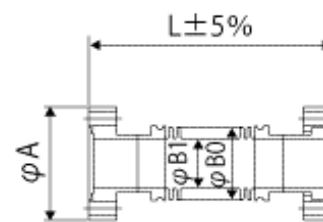
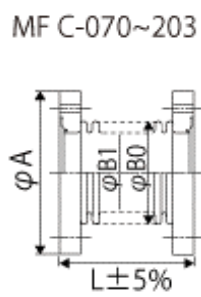

Figure: Flange one side fixed, the other side rotating

List of CF Flange Type Formed Bellows (with Flange fixed on both sides)

Code	Size	φ A	B1	B0	t	L1	L2	K	Ae
MFC-034	CF34	34	15.0	22.0	0.1	70	67-73	6.2	2.7
MFC-070	CF70	70	28.0	40.0	0.2	82	74-90	8.8	9.2
MFC-114	CF114	114	49.5	65.0	0.2	95	85-109	8.8	26.0
MFC-152	CF152	152	89.7	109.0	0.2	110	95-125	8.8	77.8
MFC-203	CF203	203	134.0	153.0	0.2	115	101-129	13.7	162.6

List of CF Flange Type Formed Bellows (with Flange fixed on one side)

Code	Size	φ A	B1	B0	t	L1	L2	K	Ae
MFC034-R	CF34	34	15.0	22.0	0.1	70	67~73	6.2	2.7
MFC070-R	CF70	70	28.0	40.0	0.2	82	74~90	5.2	9.1
MFC114-R	CF114	114	49.5	65.0	0.2	95	85~109	4.7	25.7
MFC152-R	CF152	152	89.7	109.0	0.2	110	95~125	5.3	77.5
MFC203-R	CF203	203	134.0	153.0	0.2	115	101~129	9.8	161.7

L1: Standard manufacturing length, L2: Operating range, K(N/mm): Spring constant, Ae(cm²): Effective area

※Please contact us for the information on length other than the standard length.



1100 Anadaira Sutama-cho Hokuto Yamanashi, Japan
Sales Department FAX 0551-42-5556 e-mail mpccom@mirapro.co.jp

MFP (Pipe End Type Formed Bellows)



Pressure condition: Inside: Vacuum、 Outside: Atmospheric pressure

Temperature: < 250° C

Helium leak rate: <math> < 1 \times 10^{-9} \text{Pa} \cdot \text{m}^3/\text{sec}</math>

Material: Bellows: SUS316L, Flange: SUS316

Guaranteed cycle time: 10,000 cycles

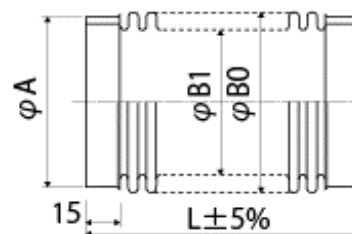

List of Pipe End Type Formed Bellows

Code	Size	ϕA	B1	B0	t	L1	L2	K	Ae
MFP-025	Pipe 20A	27.2	22.5	33.0	0.15	95	85-100	9.8	6.2
MFP-040	Pipe 32A	42.7	42.7	58.0	0.15	105	90-120	5.9	20.1
MFP-050	Pipe 50A	60.5	49.5	65.0	0.15	115	100-130	5.9	26.0
MFP-065	Pipe 65A	76.3	61.0	80.0	0.15	120	100-130	5.9	39.5
MFP-080	Pipe 80A	89.1	89.7	109.0	0.15	130	110-150	5.9	77.8
MFP-100	Pipe 100A	114.3	105.5	125.0	0.15	130	110-150	7.8	105.2

L1: Standard manufacturing length、 L2: Operating range、 K(N/mm): Spring constant、 Ae(cm²): Effective area

※Please contact us for the information on length other than the standard length.



MIRAPRO

1100 Anadaira Sutama-cho Hokuto Yamanashi, Japan

Sales Department FAX 0551-42-5556 e-mail mpccom@mirapro.co.jp

MFO (KF Pipe End Type Formed Bellows)



Pressure condition: Inside: Vacuum, Outside: Atmospheric pressure

Temperature: < 250° C

Helium leak rate: <math> < 1 \times 10^{-9} \text{Pa} \cdot \text{m}^3 / \text{sec}</math>

Material: Bellows: SUS316L, Flange: SUS316

Guaranteed cycle time: 10,000 cycles

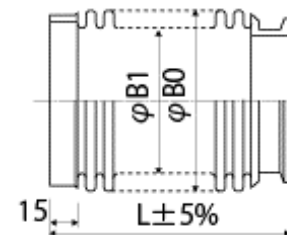

List of KF Pipe End Type Formed Bellows

Code	Size	ϕA	B1	B0	t	L1	L2	K	Ae
MFO-025	KF25x20A	-	22.5	33.0	0.15	100	90-105	9.8	6.2
MFO-040	KF40x32A	-	42.7	58.0	0.15	110	95-125	5.9	20.1
MFO-050	KF50x50A	-	49.5	65.0	0.15	120	105-135	5.9	26.0
MFO-065	KF63x65A	-	61.0	80.0	0.15	125	105-135	5.9	39.5
MFO-080	KF80x80A	-	89.7	109.0	0.15	140	120-160	5.9	77.8
MFO-100	KF100x100A	-	105.5	125.0	0.15	140	120-160	7.8	105.2

L1: Standard manufacturing length, L2: Operating range, K(N/mm): Spring constant, Ae(cm²): Effective area

※Please contact us for the information on length other than the standard length.



1100 Anadaira Sutama-cho Hokuto Yamanashi, Japan

Sales Department FAX 0551-42-5556 e-mail mpccom@mirapro.co.jp